

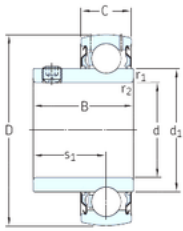

## Bearing de Mexico, S.A.

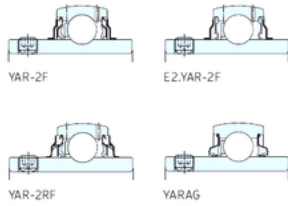

YAT



39,688 mm x 80 mm x 49,2 mm SKF  
YAR208-109-2F deep groove ball bearings

Bearing No. YAR208-109-2F

YAR208-109-2F Bearing 2D drawings and 3D CAD models

Size	39.688x80x49.2 mm
Bore Diameter	39,688 mm
Outer Diameter	80 mm
Width	49,2 mm
d	39,688 mm
D	80 mm
B	49,2 mm
C	21 mm
d1	51,8 mm
r1 min.	1 mm
r2 min.	1 mm
s1	30,2 mm
Weight	0,64 Kg
Basic dynamic load rating (C)	30,7 kN
Basic static load rating (C0)	19 kN
Fatigue load limit (Pu)	0,8