

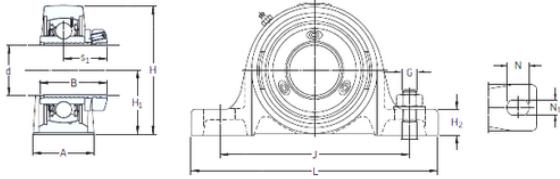

## Bearing de Mexico, S.A.



### SKF SY 2.3/16 PF/AH bearing units

Bearing No. SY 2.3/16 PF/AH

SY 2.3/16 PF/AH Bearing 2D drawings and 3D CAD models

Bore Diameter	55,5625 mm
Width	57,2 mm
d	55,5625 mm
s1	40,8 mm
A	60,4 mm
B	57,2 mm
G	16 mm
H	127 mm
H1	63,5 mm
H2	23,8 mm
J	171,5 mm
L	219 mm
N	27,5 mm
N1	18 mm
Weight	3,65 Kg
Basic dynamic load rating (C)	43,6 kN
Basic static load rating (C0)	29 kN
Category	Pillow Block Bearings
Inventory	0.0
Manufacturer Name	SKF
Minimum Buy Quantity	N/A
Weight / Kilogram	3.66
EAN	7316571782645
Product Group	M06110
Number of Mounting Holes	2
Mounting Method	Stepped Sleeve



## Bearing de Mexico, S.A.

Housing Style	2 Bolt Pillow Block
Rolling Element	Ball Bearing
Housing Material	Cast Iron
Expansion / Non-expansion	Non-expansion
Mounting Bolts	5/8 Inch
Relubricatable	Yes
Insert Part Number	YSP 211-203-2F/AH
Seals	M Seal
Housing Configuration	1 Piece Solid
Inch - Metric	Inch
Other Features	Single Row   Standard Duty   Wide Inner Race   Air Handling   Anti Rotation Pin   Has Flinger   Y Bearing   With Grub Screw
Long Description	2 Bolt Pillow Block; 2-3/16" Bore; 2-1/2" Base to Center Height; Stepped Sleeve Mount; Ball Bearing; 6-3/8" Minimum Bolt Spacing; 7-1/8" Bolt Spacing Maximum; Relubricatable; Cast
Category	Pillow Block
UNSPSC	31171511
Harmonized Tariff Code	8483.20.40.40
Noun	Bearing
Keyword String	Pillow Block
Manufacturer URL	<a href="http://www.skf.com">http://www.skf.com</a>
Manufacturer Item Number	SY 2.3/16 PF/AH
Weight / LBS	8.05
Bolt Spacing Minimum	6.375 Inch   161.925Millimeter
Base to Center Height	2.5 Inch   63.5 Millimeter
Nominal Bolt Center to Center	6.8 Inch   171.5 Millimeter



## Bearing de Mexico, S.A.

Bolt Spacing Maximum	7.125 Inch   180.975Millimeter
Bore	2.188 Inch   55.575 Millimeter
Actual Bolt Center to Center	0 Inch   0Millimeter
Length Thru Bore	2.25 Inch   57.15 Millimeter